

SHIGUERU BAN / NAKED HOUSE

Description: The radical «naked house» consists of a large open plan, in which cubical room units can be wheeled into various positions according to the moods and climatic desires of the occupants. the client wanted a house with as little privacy as possible, a house which does not separate family members from each other, but allow them space for their individual activities while retaining an atmosphere of togetherness. Based on this concept Shigeru Ban designed the transparent house container with four movable open room containers. almost without windows, no room doors,... a family of five, made up of three generations, lives there.

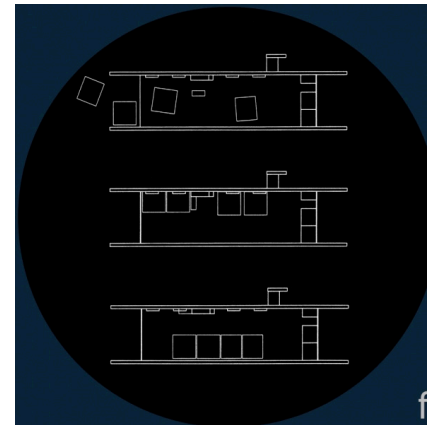

g



f



TECHNOLOGICAL LEVEL

With a look similar to neighboring greenhouse, the translucent enclosure was designed to protect the privacy of the family of possible eyes from the road

ADAPTAVILITY

This house is known for being always different, its mobile modules that make up the rooms of the house can adapt at the discretion of its inhabitants. This form of participation enables the house to be as efficient as possible to the needs of dwellers.

COMMUNAL DIMENSION

The house has a double facade of translucent polycarbonate panels that let in light and offer some thermal insulation. This is not an element of high-tech but its importance lies in taking advantage of the same material for lighting and isolation.

INDIVIDUAL DIMENSION

The house offers the opportunity to experience private space without sacrificing space. It gives a hole new interpretation of what it means «private» and how it differs from «intimacy» therefore is almost imposible to enclosure rooms and identify spaces because the house is only a unique space, apart from the bathrooms, its dwellers are the ones who give

HOSES WITH SIMILARITIES

12 container house

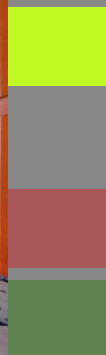

modular 1 house



houses in mulhouse

